

# 800H1HZ4CY

Allen-Bradley 800H Enclosure ThermoPlas Poly 1 Hole 3 4 Inch  
conduit Entry Yellow for 30.5mm PB



**Allen-Bradley**

by ROCKWELL AUTOMATION

PUSHBUTTON AND PILOT LIGHTS



<b>Component type</b>	Control circuit devices combination in enclosure
<b>Range</b>	800T/H Pushbutton
<b>Model</b>	N/A
<b>Product status</b>	Existing

The Allen-Bradley 800T/H range of 30.5mm mount operators are designed and constructed to perform in the most demanding industrial environments. The range includes pushbuttons, selector switches, emergency stops, pilot lights. Available in both metal and plastic types with a modular design allowing for easy selection, configuration and assembly of components to form the operator control device.

## CONSTRUCTION

Number of push buttons	1.0
Number of key switches	1.0
Number of selector switches	1.0
Number of mushroom-shaped push-buttons	1.0
Colour housing cover	Yellow
Material housing	Plastic

## MECHANICAL

Vibration acceleration (Max)	10.0 m/s <sup>2</sup>
Vibration frequency, operational (Max)	2000.0 Hz
Shock acceleration (Max)	100.0 g

## DIMENSIONS

Height	110.0 mm
Width	80.0 mm
Depth	50.0 mm

## ENVIRONMENT

Operating temperature	-40 - 55
-----------------------	----------

# 800H1HZ4CY

Allen-Bradley 800H Enclosure ThermoPlas Poly 1 Hole 3 4 Inch  
conduit Entry Yellow for 30.5mm PB



**Allen-Bradley**

by ROCKWELL AUTOMATION  
PUSHBUTTON AND PILOT LIGHTS

## DIMENSIONAL DIAGRAM

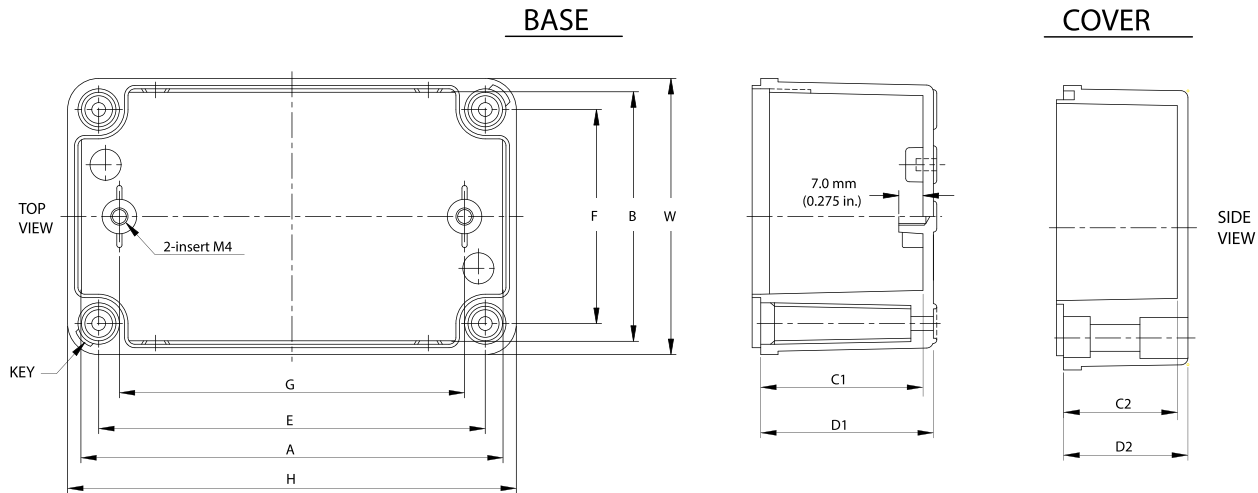

Thermoplastic Polyester Type 4/4X

Cat. No.	Overall Dimension			Inside Dimension				Enclosure Mounting Dimension		Mounting Plate Mounting Dim.	
	H	W	D1	D2	A	B	C1	C2	E		F
800H-1HZ4__	110 (4.33)	80 (3.15)	50 (1.97)	20 (0.79)	104 (4.09)	74 (2.91)	46.5 (1.83)	16.5 (0.65)	92 (3.62)	62 (2.44)	80 (3.15)
800H-2HZ4__	130 (5.12)	80 (3.15)	50 (1.97)	35 (1.38)	120 (4.72)	70 (2.76)	46.5 (1.83)	31.5 (1.24)	112 (4.41)	62 (2.44)	100 (3.94)
800H-3HZ4__	180 (7.09)	80 (3.15)	50 (1.97)	35 (1.38)	170 (6.69)	70 (2.76)	46.5 (1.83)	31.5 (1.24)	162 (6.38)	62 (2.44)	150 (5.91)
800H-4HZ4__	250 (9.84)	80 (3.15)	50 (1.97)	35 (1.38)	240 (9.45)	70 (2.76)	46.5 (1.83)	31.5 (1.24)	232 (9.13)	62 (2.44)	220 (8.66)